

### IMPORTANT:

Disconnect power to the garbage disposal. Remove the garbage disposal knock-out plug if still present. Tap away all edges until a round hole remains. Remove all loose pieces from the inside the disposal. Run fingers carefully around the bottom of the disposal chamber to locate any fragments.

### WARNING:

Exercise extreme caution whenever reaching hand inside the garbage disposal. After confirming that power has been turned off (and will stay off until the job is complete), use extra care not to cut fingers on sharp surfaces.

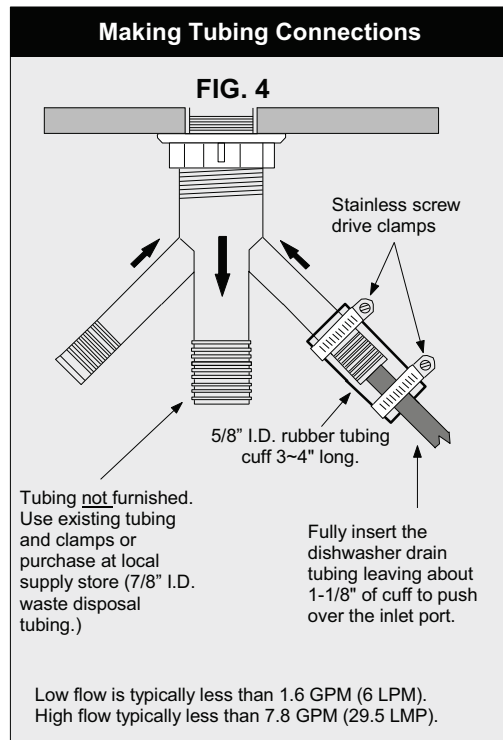

### REPLACEMENT INSTALLATION:

Replace an existing dishwasher air gap with the AG200-007.

1. Disconnect hoses from existing air gap. Save hose clamps for reassembly.
2. Remove the existing air gap from a sink or countertop. Clean the surface before installing the AG200-007.
3. Follow instructions under the new installation section.

### MAINTENANCE:

Dishwasher air gaps may clog with food debris escaping the dishwasher filter. The AG200-007 is easy to clean in the event of a clog.

1. Remove the decorative cover cap and unscrew the top nut. Remove the top housing and remove any trapped food particles.
2. Replace top housing. Align housing key with slot in the main body, Fig.2.
3. Install the top nut before replacing the Cover cap.



Copyright AIR GAP INTERNATIONAL



Placentia, California



Model:

# AG200-007

## TWIN, EXTRA LONG THREAD AIR GAP WITH 1/4" RO PORT FOR TANKLESS RO SYSTEM

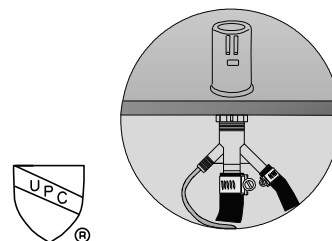

**(Maximum flow rate 12 GPM)**

### COMPATIBILITY:

AG200-007 is not compatible with reverse osmosis faucets with air gap.

AG200-007	AIRGAP WITH CHROME FINISH PLASTIC CAP
AG200-107	AIRGAP WITH BRUSHED NICKEL FINISH BRASS CAP
AG200-207	AIRGAP WITH POLISHED CHROME FINISH BRASS CAP
AG200-307	AIRGAP WITH OIL RUBBED BRONZE FINISH BRASS CAP
AG200-407	AIRGAP WITH BRUSHED STAINLESS STEEL FINISH BRASS CAP
AG200-507	AIRGAP WITH BLACK MATT FINISH BRASS CAP
AG200-607	AIRGAP WITH POLISHED NICKEL FINISH BRASS CAP
AG200-707	AIRGAP WITH SATIN NICKEL FINISH BRASS CAP
AG200-807	AIRGAP WITH BRUSHED BRONZE FINISH BRASS CAP

# AG200-007

## Installation Procedures

**Caution - Do Not Overtighten Nuts or Clamps**

### LIST OF PARTS ENCLOSED

- 1 – Main Body
- 1 – Cover Cap
- 1 – Bottom Nut
- 1 – Washer

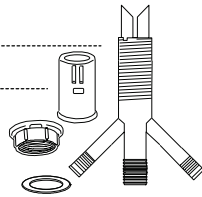

- 1 – Top Housing
- 1 – Mounting Nut
- 1 – Top Nut
- 1 – Inlet Plug

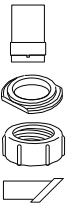

The AG200-007 is a dishwasher / RO system air gap that provides many advantages over other air gaps.

A dishwasher /RO air gap is critical in maintaining a safe water supply preventing drain waste from flowing into the dishwasher/RO and is required by code in most states.

It ensures safety and peace of mind that your water supply is clean.

Read instructions once through before starting.

## NEW INSTALLATION

- Unit installation requires a 1-3/8-inch hole in the sink or countertop.
- Unscrew top nut from main body and remove mounting nut and washer. Turn the bottom nut down the main body so about 1" of threads protrude up through mounting hole, Fig. 1.
- Insert the air gap from the bottom through the hole in the sink. Reinstall the washer, mounting nut, housing (Fig. 2) and top nut over the threaded main body.

The air gap is loose in the hole until the bottom nut is tightened later.

- If only RO is needed, use plug provided to cover the dishwasher port. Remove top housing, add plug, replace housing carefully rotating until housing key aligns with key slot in the main body, Fig. 2.

- Install top nut over the housing and screw it down until it touches the mounting nut.

The top nut must hold housing firmly in place to prevent leaks. Lower the mounting nut until the top nut holds the housing firmly in place, then raise

- Align inlets and outlet under the sink as desired. Pull down on the air gap while tightening the bottom nut clockwise. DO NOT OVER-TIGHTEN.

- Install decorative cap by pushing it down over the housing. Rotate the decorative cap so that the two air gap openings face the sink, Fig. 4.

- Connect dishwasher drain hose to the 5/8" inlet 2 with hose clamp. Fig. 3.

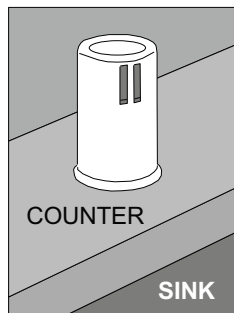
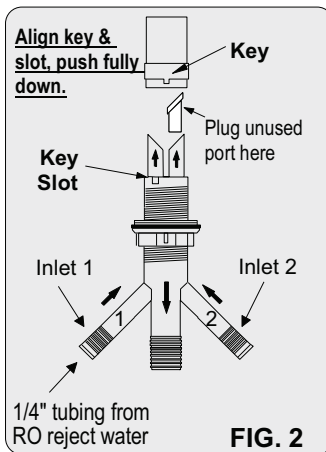
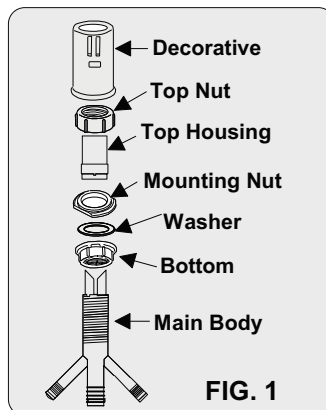

FIG. 4

**CAUTION:** No tools, use hands only above the sink.

**CLEANING:** Use mild soap and water to clean decorative cap. Do not clean with abrasive cleaners.

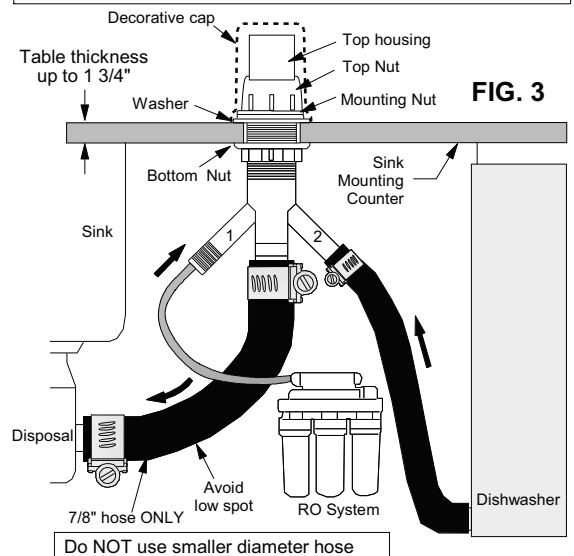
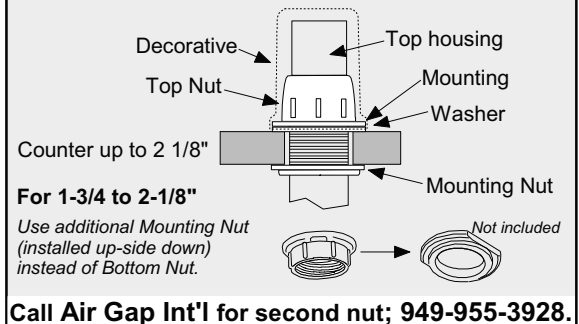

FIG. 3

### Counters 1-3/4" to 2-1/8" Thick



**Call Air Gap Int'l for second nut; 949-955-3928.**

- Connect 1/4-inch tubing from RO unit into 1/4-inch push-in connector in inlet port 1, Fig. 3.

- Connect the outlet to garbage disposal drain inlet using 7/8-inch ID waste disposal tubing and two hose clamps, Fig. 3.

- See Fig. 5 if you need to make tubing (not hose) connection to the dishwasher inlet