

10. Connect the AG200-004 outlet to the garbage disposal drain inlet using a length of 7/8" dishwasher drain line hose and two hose clamps.

IMPORTANT:

Remove the garbage disposal knock-out plug if still present. Tap away all edges until a round hole remains. Disconnect power to the garbage disposal unit and then remove all loose pieces from the inside the disposal. Run fingers carefully around the bottom of the disposal chamber to locate any fragments. (See Warning below)

WARNING:

Exercise extreme caution whenever reaching hand inside the garbage disposal. After confirming that power has been turned off (and will stay off until the job is complete), use extra care not to cut fingers on sharp surfaces.

REPLACEMENT INSTALLATION:

Replace an existing dishwasher air gap with the AG200-004.

- 1. Disconnect drain hoses from the existing air gap. Save hose clamps for reassembly.
- 2. Remove the existing air gap from a sink or countertop. Clean the surface before installing the AG200-004.
- 3. Follow instructions under the new installation section.

MAINTENANCE:

Dishwasher air gaps may clog with food debris escaping the dishwasher filter. The AG200-004 is easy to clean in the event of a clog.

- 1. Remove the decorative cover cap and unscrew the top nut. Remove the top housing and remove any trapped food particles.
- 2. Replace top housing. Align housing key with slot in the main body, Fig.2.
- 3. Install the top nut before replacing the Cover cap.

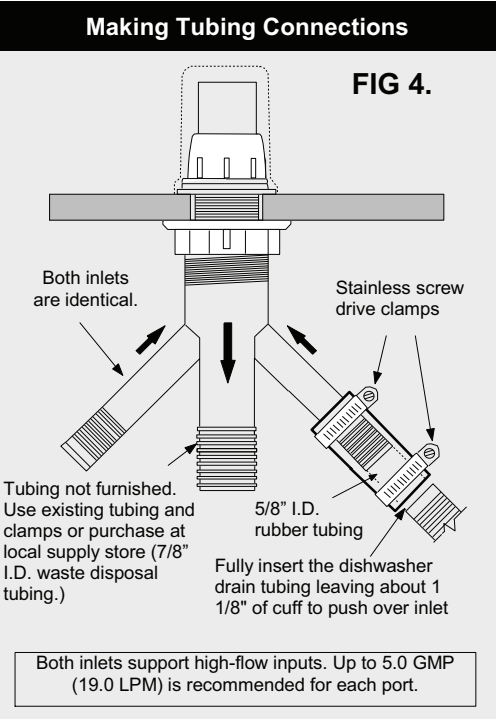

Placentia, California



Model:
AG200-X04
AMERIGAP

DUAL INLET DISHWASHER AIR GAP

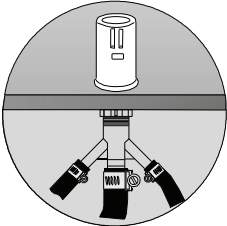

(Maximum flow rate 11 GPM)



AG200-004	AIRGAP WITH CHROME FINISH PLASTIC CAP
AG200-104	AIRGAP WITH BRUSHED NICKEL FINISH BRASS CAP
AG200-204	AIRGAP WITH POLISHED CHROME FINISH BRASS CAP
AG200-304	AIRGAP WITH OIL RUBBED BRONZE FINISH BRASS CAP
AG200-404	AIRGAP WITH BRUSHED STAINLESS STEEL FINISH BRASS CAP
AG200-504	AIRGAP WITH BLACK MATT FINISH BRASS CAP
AG200-604	AIRGAP WITH POLISHED NICKEL FINISH BRASS CAP
AG200-704	AIRGAP WITH SATIN NICKEL FINISH BRASS CAP
AG200-804	AIRGAP WITH BRUSHED BRONZE FINISH BRASS CAP

AG200-004

Installation Procedures

Caution - Do Not Overtighten Nuts or Clamps

LIST OF PARTS ENCLOSED

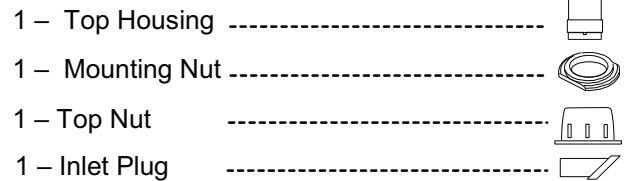
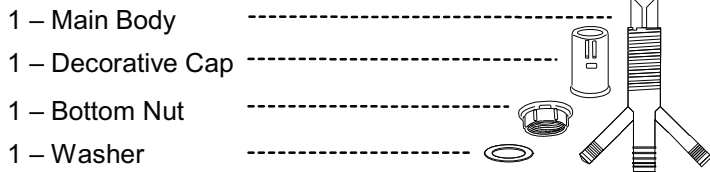

A dishwasher air gap is critical in maintaining a safe water supply. It prevents contaminants in the sink from flowing into the dishwasher and is required by code in most states.

The Amerigap brand dual dishwasher air gap provides many advantages over other air gaps and ensures safety and peace of mind that your water supply is clean.

Read instructions once through before starting.

NEW INSTALLATION

- Unit installation requires a 1-3/8-inch hole in the sink or countertop.
- Unscrew top nut from main body and remove mounting nut and washer. Turn the bottom nut down the main body so about 1" of threads protrude up through mounting hole, Fig.1.
- Insert the air gap from the bottom through the hole in the sink. Reinstall the washer, mounting nut and top nut over the threaded main body of the unit.
- If only port is needed, use plug provided to cover the second port. Remove top housing, add plug, replace housing carefully rotating until housing key aligns with key slot in the main body, Fig. 2.
- Install top nut over the housing and screw it down until it touches the mounting nut.

Top nut must hold housing firmly in place to prevent leaks. Lower the mounting nut until the top nut holds the housing firmly in place, then raise mounting nut.

- Align inlets and outlet under the sink as desired. Pull down on the air gap while tightening the bottom nut clockwise. **DO NOT OVER-TIGHTEN.**

- Install decorative cap by pushing it down over the housing. Rotate the decorative cap so that the two air gap openings face the sink. Fig 4.

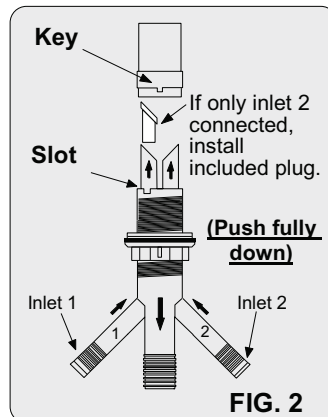
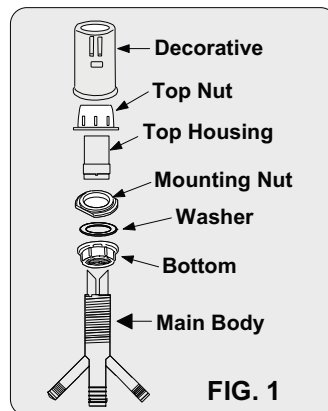

CAUTION: No tools, use hands only above the sink.

CLEANING: Use mild soap and water to clean decorative cap. Do NOT clean with abrasive cleaners.

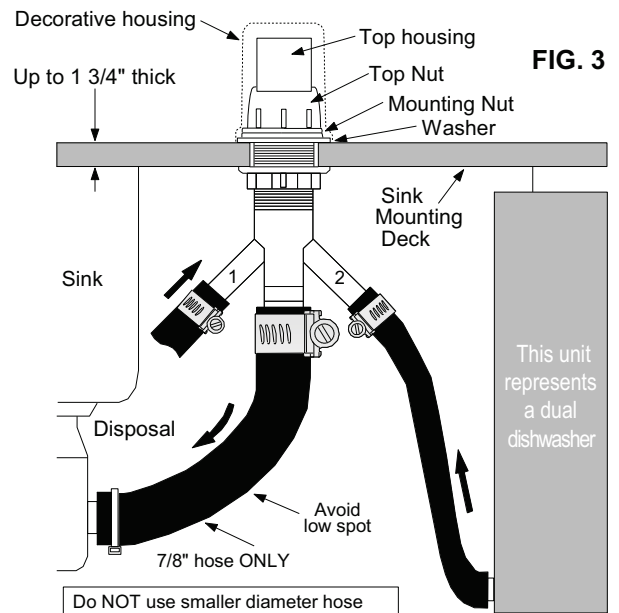

Counters 1-3/4" to 2-1/8" Thick

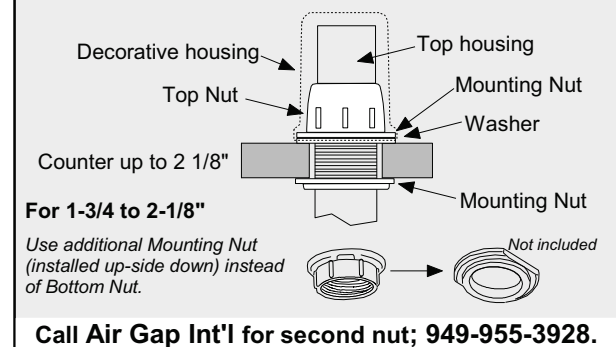

- Connect the dishwasher drain hoses to the 5/8-inch inlets using hose clamps.

- See Fig. 5 for other ways to connect to the air gap.