

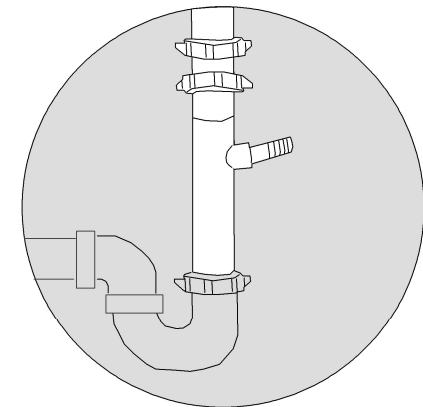

**Model:**  
**ET113-001**

**1-1/2" X 8" - 5/8" BRANCH,  
WATER SOFTENER DRAIN  
ADAPTER**

► For Single Compartment  
Sink without Disposal



MADE IN USA  
ASTM F 409



ASTM F 409

Serving the  
Reverse Osmosis  
Water Treatment Industry



Copyright © AIRGAP INTERNATIONAL a Division of Altinex Inc.

# ET113-001

## Installation Procedures

For Single Compartment Sink without Disposal

### LIST OF PARTS ENCLOSED

- 1 – Branch Tailpiece.....
- 1 – Flanged Tailpiece.....
- 2 – Slip Joint Wing Nuts.....
- 1 – Slip Joint Beveled Washers .....

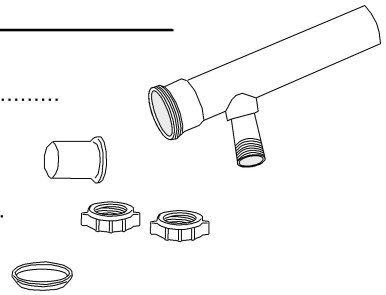

- *The ET113-001 is designed to connect a water softener to a plumbing drainage system.*
- *The branch of the ET113-001 accommodates 5/8-inch ID drain hose from water softener.*

### CONFIGURATION – (Recommended)

1. Disconnect tailpiece from the sink. Remove J-bend from disposal and trap. Use a bowl to catch trap water. (See Fig. 1)

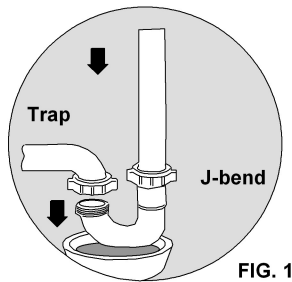

FIG. 1

5. Replace J-bend by sliding onto trap and tailpiece of ET113-001 simultaneously. Secure tightly by reusing original nuts and washer. (See Fig. 4)

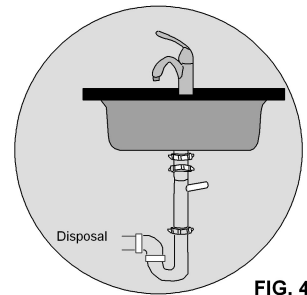

FIG. 4

2. Reuse gasket from under the sink connection by mounting on the flanged tailpiece part of ET113-001. (See Fig. 2)

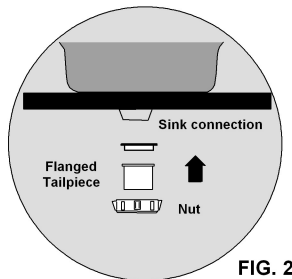
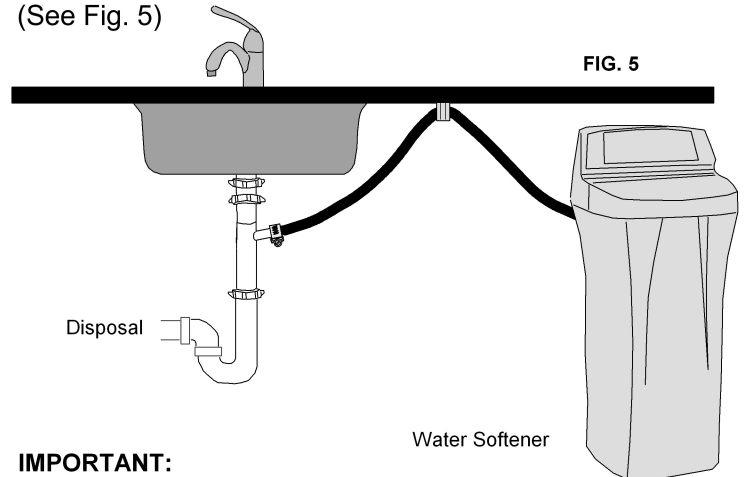

FIG. 2

3. Using provided nut, connect flanged tailpiece under the sink. (See Fig. 2)

6. Connect the 5/8" drain tube to the barb on ET113-001 branched tailpiece using hose clamp. (See Fig. 5)



#### IMPORTANT:

- Tube should be lower on drain side than disposal side.

#### CAUTION:

- Be careful not to overtighten nuts on plastic fittings.
- Check for leak-free connection.
- Long tubes may require mechanical support.

4. Install branch tailpiece of ET113-001 drain line adapter to the end of flanged tailpiece under the sink using provided washer and wing nut. (See Fig. 3)

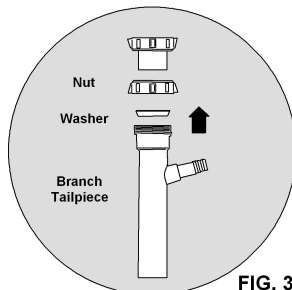

FIG. 3