

CONFIGURATION – B

Optional (Horizontal Installation)

1. Measure the midpoint on the horizontal waste ell and cut out 1-1/2-inch tubing. (See Fig. 7)

2. Slip the nut and beveled waster over both ends of the cut tube, then insert the 3-way repair tee in the following manner: Loosen the nut on the horizontal waste L where it joins the vertical tailpiece. (See Fig. 8) Remove the short “ell” piece by pulling down the tailpiece. (Fig. 8), then, put the cut ends L into a tee, tilt the vertical end back up over the tailpiece and re-secure the nut. Rotate the tee so that the side outlet is facing straight up, then firmly tighten both nuts to a tee. (See Fig. 9)

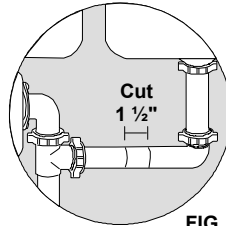

FIG. 7

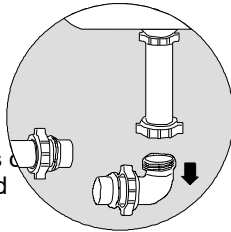

FIG. 8

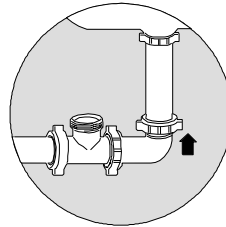

FIG. 9

OPTIONAL: To further decrease or eliminate reject water noise, rotate the side outlet for a tee from vertical down to 45 degrees.

3. Follow instructions 5 & 6 (configuration – A) to complete installation.

CAUTION: Be careful not to “over-tighten” any screw on plastic fittings.

CONFIGURATION – C

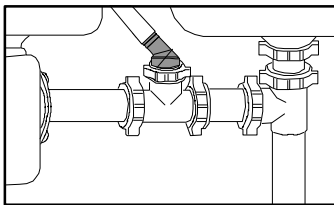

NOTE:

To connect a dishwasher water drain line to the plumbing of a single compartment sink with disposal.

MADE IN USA
ASTM F 409



Model:

ET112-004

DISHWASHER/WATER SOFTENER DRAIN LINE ADAPTER

► For Multi-Compartment Sinks
-OR-
Single-compartment Sink
without Disposal



ASTM F 409

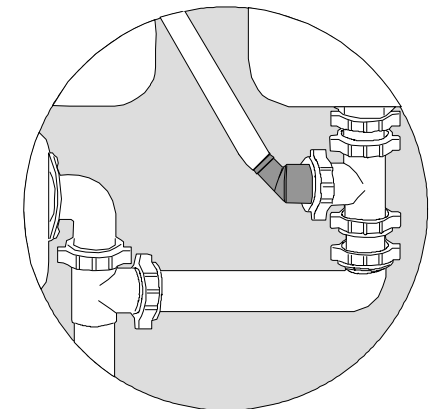



ET112-004

Installation Procedures

For Multi Compartment Sinks or Single
Compartment Sink without Disposal

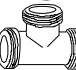
LIST OF PARTS ENCLOSED

1pc – Drain Line Adapter with 7/8 Barb Connection	
1pc – 3-Way Repair Tee.....	
3pcs – Slip Joint Wing Nuts	
3pcs – Slip Joint Beveled Washers	

•The ET112-004 provides an IAPMO / UPC listed alternative to the use of the drain saddle, which is a prohibited fitting in the United States.

• To install the ET112-004 drain line adapter, follow these instructions.

Please read the instructions once through before starting.

CONFIGURATION – A Recommended (Vertical Installation)

1. Measure the midpoint on the vertical tailpiece between the basket strainer and the horizontal waste pipe extension. A minimum of 4 inches of uninterrupted tubing is required. (See Fig. 1)

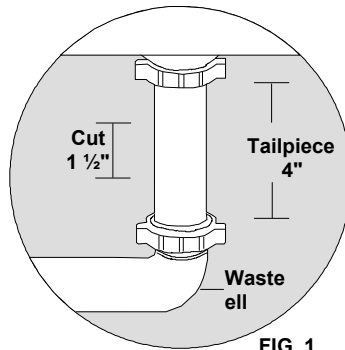

2. Cut out 1 -1/2 -inch of tubing (3/4 inch on both sides of midpoint). (See Fig. 1) Always ensure that tube ends are cut squarely and inserted into the bottom of all slip joint sockets.

3. Slip the nut and beveled washer over both pipe ends. Always face the beveled side of the washer towards the fitting. (See Fig. 2) Then insert the 3-way tee, ensuring that the tube ends seat fully into the sockets of the tee. This may be accomplished by loosening the nut joining the horizontal waste L to the baffle tee until there is enough play to bend the waste L down and then up into the bottom of the 3-way tee. (See Fig. 3)

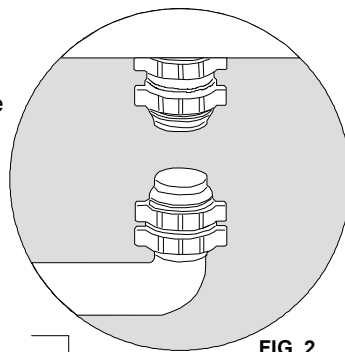

4. Rotate the side outlet of the repair tee in the desired direction and firmly tighten the top and bottom slip joint nuts. Now, secure the waste L to the baffle tee.

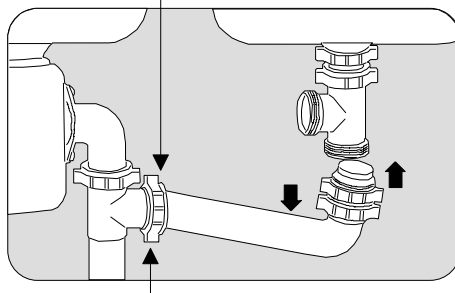

5. Insert a new drain line adapter with a barb into the side outlet of the tee and rotate towards the incoming 7/8-inch dishwasher water drain tube. Ensure that the adapter is firmly seated to the bottom of the socket, then tightly secure with a beveled washer and wing nut. (See Fig. 4)

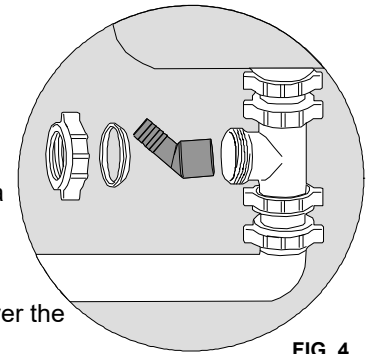

6. Insert a 7/8-inch drain tube over the barb connector to complete the installation. (See Fig. 5)

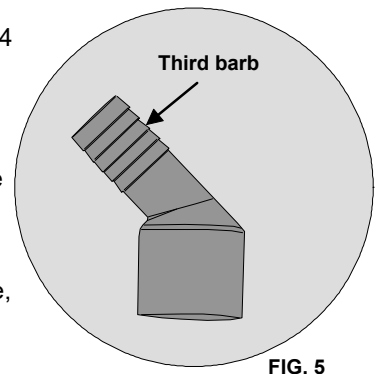

NOTE: To install the ET112-004 to a single-compartment sink without disposal, follow instructions 1-6 above with the following exception: Once you have removed 1-1/2-inch of the tubing from the center of the tailpiece (Fig. 1), disconnect and lower the J-bend of the trap. Insert the 3-way repair tee, then reconnect the trap. Use a bowl to catch trap water. (See Fig. 6)

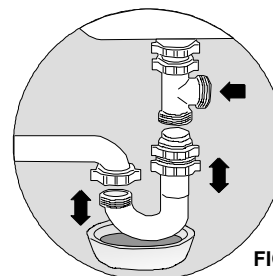

CAUTION:

- To ensure a leak-free connection, the tubing must sit fully up to the third barb. (See Fig. 5)
- Check that the connection is leak-free.

FIG. 6