

11. If tubing is needed to connect to the dishwasher inlet port 1 of the AG200-010, see Fig.5.

12. Connect the AG200-010 outlet to the garbage disposal drain inlet using 7/8-inch ID waste disposal tubing and two hose clamps. (See Fig.3)

IMPORTANT:

Disconnect power to the garbage disposal unit. Remove the garbage disposal knock-out plug if still present. Tap away all edges until a round hole remains, and remove all loose pieces inside the disposal. Run fingers carefully around the bottom of the disposal chamber to locate any fragments. (See Caution below)

CAUTION:

Exercise extreme caution whenever reaching your hand inside the garbage disposal. After confirming that power has been turned off (and will stay off until the job is complete), use extra care not to cut fingers on sharp surfaces.

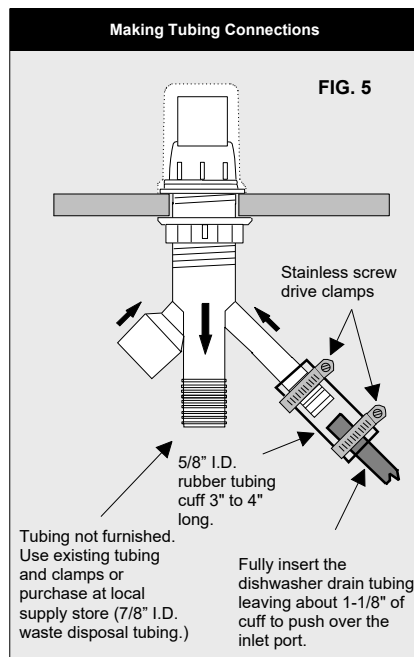

REPLACEMENT INSTALLATION

(To replace an existing dishwasher air gap with the AG200-010)

1. Disconnect inlet and outlet drain hoses/tubes from the existing air gap. Save hose clamps for reassembly.
2. Remove the existing air gap from a sink or countertop. Clean the surface before installing the AG200-010.
3. Follow the instructions under the new installation section.

MAINTENANCE:

Dishwasher air gaps may become clogged with leftover food debris escaping the dishwasher's filtering mechanism. The AG200-010 is easy to clean in the event of a clog.

To clear a blockage, remove the decorative cover cap and unscrew the top nut. Then, remove the top housing, slide it straight up, and remove any trapped food particles.

After cleaning, carefully replace the top housing. Install the top nut before replacing the decorative cap.



Copyright AIR GAP INTERNATIONAL

500 Jefferson St. Placentia, CA 92870 USA • 949-955-3928 • Email: orders@airgap.com



Placentia, California



Model:
AG200-X10

**UNIVERSAL DUAL AIR GAP WITH LONG BODY
THREAD, 1/2" MIPT AND 5/8" OD INLETS,
AND 7/8" OUTLET.**

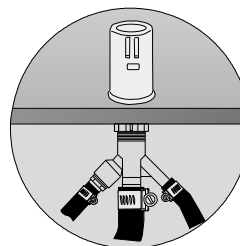

(Maximum flow rate 10 GPM)

AG200-010	AIRGAP WITH CHROME FINISH PLASTIC CAP
AG200-110	AIRGAP WITH BRUSHED NICKEL FINISH BRASS CAP
AG200-210	AIRGAP WITH POLISHED CHROME FINISH BRASS CAP
AG200-310	AIRGAP WITH OIL RUBBED BRONZE FINISH BRASS CAP
AG200-410	AIRGAP WITH BRUSHED STAINLESS STEEL FINISH BRASS CAP
AG200-510	AIRGAP WITH BLACK MATT FINISH BRASS CAP
AG200-610	AIRGAP WITH POLISHED NICKEL FINISH BRASS CAP
AG200-710	AIRGAP WITH SATIN NICKEL FINISH BRASS CAP
AG200-810	AIRGAP WITH BRUSHED BRONZE FINISH BRASS CAP

Doc. # 400-0856-004

AG200-010

Installation Procedures

LIST OF PARTS ENCLOSED

- 1 – Main Body
- 1 – Cover Cap
- 1 – Bottom Nut
- 1 – Washer
- 1 – Mounting Nut

- 1 – Top Housing
- 1 – Top Nut
- 1 – Inlet Plug
- 1 – 1/2" MIPT X 5/8" Barb adapter
- 1 – Adapter washer

Optional accessories list

ET170-002
(1/2" MIPT x 3/8" Quick connect adapter)

ET170-004
(1/2" MIPT x 5/8" Quick connect adapter)

ET170-003
(1/2" MIPT x 1/2" Quick connect adapter)

ET170-005
(1/2" MIPT x 1/2" Barb adapter)

ET170-006
(1/2" MIPT x 1/2" Angled Barb adapter)

ET170-008
(1/2" MIPT x 5/8" Angled Barb adapter)

ET170-017 (1/2" MIPT Plug)

The AG200-010 universal dishwasher air gap provides convenience and flexibility when installing dual-drawer dishwashers, RO filters, and water softeners.

A dishwasher air gap is critical in maintaining a safe water supply. It prevents contaminants in the sink from flowing into the dishwasher and is required by code in most states. It ensures safety and peace of mind that your water supply is clean.

Please read the instructions once through before starting.

NEW INSTALLATION

1. Unit installation requires a 1-3/8-inch hole in a countertop.

2. Unscrew the top nut from the AG200-010 body. Next, unscrew and remove the mounting nut and the washer. Turn the bottom nut further down the air gap's body. Leave sufficient length for the thread to protrude up through the mounting hole. (See Fig.1)

3. Install washer and screw 1/2" x 5/8" adapter into port 2. (See Fig.2) Depending on the required connection, a 1/2" MIPT x 5/8" adapter can be changed to an appropriately sized barb or push-in fitting from the ET170 optional accessories list (ordered separately).

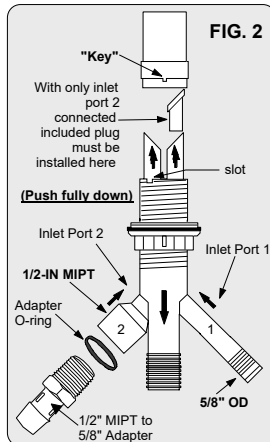

4. Connect the dishwasher drain hoses to the 5/8-inch inlet ports of the AG200-010 with hose clamps.

5. If quick-connect adapters from the optional ET170 list are used, the tube must be pushed past the internal O-ring to provide a proper seal. Verify that the tube surface is free of scratches and that the tube end is cut square. The tube may be removed by removing the locking clip and depressing the push-in collet evenly against the adapter, then simultaneously pulling the tube out in the opposite direction. (See Fig. 3)

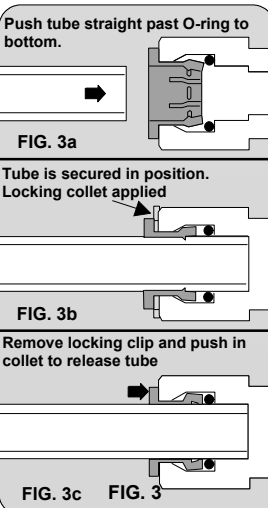
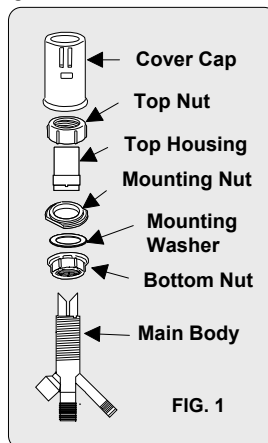

6. If only one inlet is needed, use the plug provided to cover the unused port. Remove the top housing by pulling it up. Install the plug and place the top housing back by pushing down and carefully rotating it until the top housing key engages with the slot in the threaded body. (See Fig. 2).

7. Insert the air gap from the bottom through the hole in the countertop. Orient the bottom inlets and outlet under the sink as desired. Reinstall the washer and mounting nut.

8. Ensure that the top housing is seated correctly. Install the top nut over the top housing and screw it down until it touches the mounting nut.

9. Pull down on the air gap while tightening the bottom nut clockwise. (See Fig. 4) DO NOT OVER-TIGHTEN.

10. Install the decorative cap (different cap finishes are available) by pushing it down over the top housing. Rotate the decorative cap so the two air gap openings face the sink.

To clean the decorative cap, use mild soap and water. Do not clean with abrasive cleaners.

CAUTION: (NO TOOLS) Use hands only above the sink

