

13. See Fig. 6 if you need to make a tubing connection to the dishwasher inlet port 1 of the AG200-010.

14. Connect the AG200-010 outlet to the garbage disposal drain inlet using 7/8-inch ID waste disposal tubing and two hose clamps. (See Fig.4)

IMPORTANT:

Disconnect power to the garbage disposal unit. Remove the garbage disposal knock-out plug if still present. Tap away all edges until a round hole remains, and remove all loose pieces inside the disposal. Run fingers around the bottom of the disposal chamber to locate fragments. (See Caution below.)

CAUTION:

Exercise extreme caution whenever reaching your hand inside the garbage disposal. After confirming that power has been turned off (and will stay off until the job is complete), do not cut your fingers on sharp surfaces.

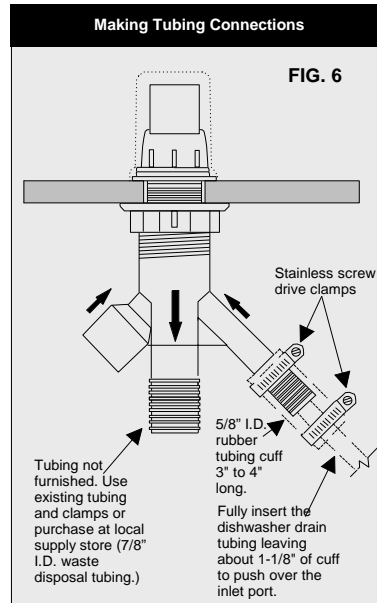

REPLACEMENT INSTALLATION

(To replace an existing dishwasher air gap with the AG200-010)

1. Begin by disconnecting the inlet and outlet drain hoses/tubes from the existing air gap. Remember to save the hose clamps for reassembly.
2. Remove the existing air gap from a sink or countertop. Clean the surface before installing the AG200-010.
3. Follow the instructions under the new installation section.

MAINTENANCE:

Dishwasher air gaps may become clogged with leftover food debris escaping the dishwasher's filtering mechanism. The AG200-010 is easy to clean in the event of a clog.

To clear a blockage, remove the decorative cover cap and unscrew the top nut. Then, remove the top housing, slide it straight up, and remove any trapped food particles.

After cleaning, carefully replace the top housing. Install the top nut before replacing the decorative cap.



Model:

AG170-031

RO KIT FOR AG200-010

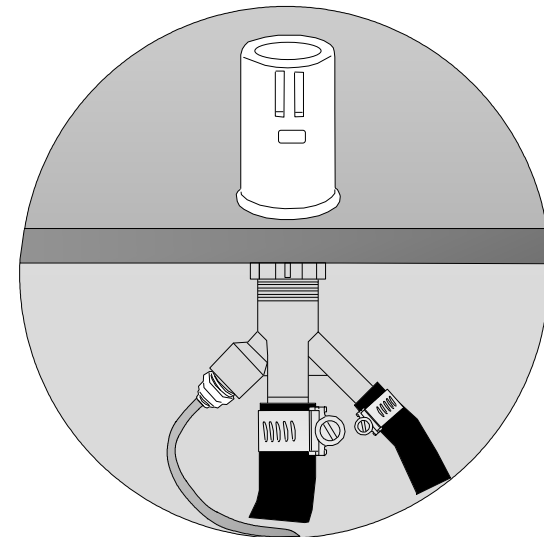

(Maximum flow rate 0.6 GPM)



AG170-031

Installation Procedures

LIST OF PARTS ENCLOSED

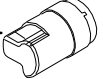
| | | | | | |
|--|-------|---|---------------------|-------|---|
| 1 – 1/2" MIPT X 1/4" Quick Connect Adapter | ----- |  | 1 – Flow controller | ----- |  |
| 1 – 1/4" Tube Locking Clip | ----- |  | 1 – RO Top housing | ----- |  |

AG170-031 is an RO kit sold separately from AG200-010 for use as an RO system air gap.
The AG200-010 with AG170-031 (RO kit) provides many advantages over other air gaps on the market, including quiet operation, no need for drill drain pipe, compatibility with all RO systems, and ease of installation.

Please read the instructions once through before starting.

NEW INSTALLATION

1. Unit installation requires a 1-3/8-inch hole in a countertop.

2. Unscrew the top nut from the AG200-010 body. Pull up the top housing to remove it. Next, unscrew and remove the mounting nut and the washer. Turn the bottom nut further down the air gap's body. Leave sufficient length for the thread to protrude up through the mounting hole.
 (See Fig.1)

3. If only only inlet 2 is needed, use the plug provided to cover the port 1. (See Fig.2)

4. For usage of AG200-010 for RO drain 1/4" tube connection, install AG170-031 RO kit. Install AG170-031 flow controller into top port. Dip the part into the water before installation.
 (See Fig. 3).

5. Replace the provided AG200-010 top housing with the top housing from the AG170-031 kit by pushing down and carefully rotating it until the top housing key engages with the slot in the threaded body. (See Fig. 3)



6. Install the top nut over the top housing and screw it down until it touches the mounting nut.

7. Install O-ring (provided with AG200-010) and 1/2" MIPT X 1/4" quick connect adapter provided with AG170-031 into input port 2.
 (See Fig.3)

8. Connect the dishwasher drain hose to the 5/8-inch inlet port 2 of the AG200-010 with hose clamps.

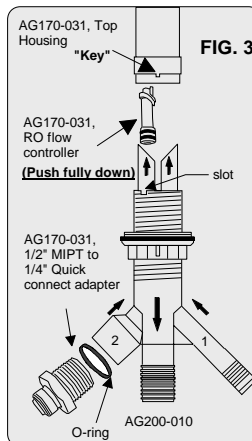
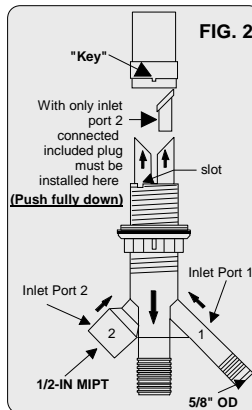
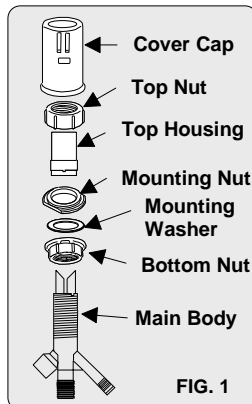

9. Fully insert the RO drain tube into 1/4" Quick connect adapter. The RO drain tube must be pushed past the internal O-ring to provide a proper seal. Verify that the tube surface is free of scratches and that the tube end is cut square before installation. Use AG170-031 locking clip to secure connection. The tube may be removed by removing the locking clip and depressing the push-in collet evenly against the adapter, then simultaneously pulling the tube out in the opposite direction. (See Fig. 4)

10. Insert the AG200-010 from the bottom through the hole in the countertop. Reinstall the washer and mounting nut.

11. Orient the bottom inlets and outlet under the sink as desired. Pull down on the air gap while tightening the bottom nut clockwise.
DO NOT OVER-TIGHTEN.

12. Install the decorative cap (different cap finishes are available) by pushing it down over the top housing. Rotate the decorative cap so the two air gap openings face the sink.

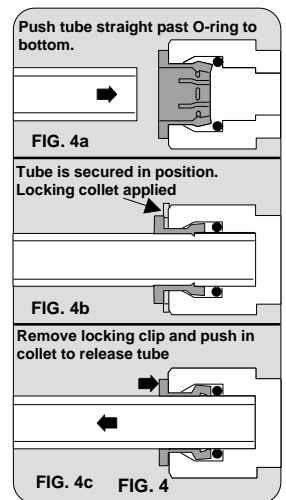

To clean the decorative cap, use mild soap and water. Do not clean with abrasive cleaners. **CAUTION: (NO TOOLS)** Use hands only above the sink

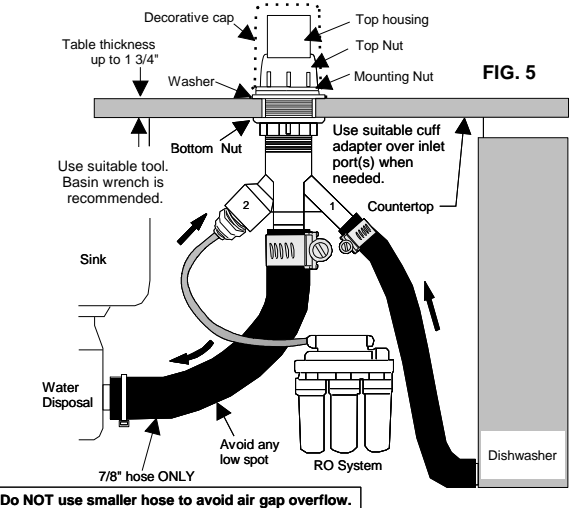

Do NOT use smaller hose to avoid air gap overflow.